

16 Daneshill Road, Leicester, LE3 6AL

Rent My Home are pleased to present this stylish STUDIO APARTMENT located on Daneshill Road, Leicester, LE3. This property is available to view NOW, and move in from 12th June 2025, so call us today to book your viewing!

This ground floor apartment briefly comprises of a open plan lounge/bedroom, a separate fitted kitchen with white appliances and a contemporary bathroom with fitted bathtub and overhead shower unit.

The property benefits from having double glazed windows throughout and high quality electric storage heaters installed as well as internal wall insulation to generate good heat retention within the property itself.

Located just off Fosse Road Central, this property lends itself to being within close proximity to all local shops and supermarkets and has fantastic links to Leicester City Centre and Royal Infirmary Hospital as well.

Viewing is highly recommended so please feel free to call Rent My Home on 0116 229 1021 today for more information!

Property ID: 15416407

£525 PCM

16 Daneshill Road

, Leicester, LE3 6AL



- *** SPACIOUS STUDIO APARTMENT ***
- Separate Fitted Kitchen with White Appliances
- Double Glazed Windows Throughout
- Available from 12th June 2025, Zero Deposit Option Available.
- Unfurnished Accommodation
- Stylish Fitted Bathroom Suite
- Ideal for Working Professionals or Students
- Large Open Plan Lounge/Bedroom
- Good Quality Electric Heating Installed
- Close to all Local Shops and Supermarkets



Directions



MOVE IN FASTER WITH ZERO DEPOSIT[™]

0 ZERO
DEPOSIT.
COM

RENT DEPOSIT-FREE TODAY



Easier

Break free from
the deposit cycle.
Use your money for
what matters most



Faster

No need to save for
months. Secure your
new home within days



Fairer

Partnered with TDS
for impartial dispute
resolution

1

Get Referred

Ask your letting agent if
the landlord accepts
Zero Deposit*



Purchase Guarantee

Pay a low upfront fee
instead of a traditional deposit



End of Tenancy

If no issues, the guarantee
ends. Disputes are fairly
assessed by TDS

Ground Floor

Approx. 37.6 sq. metres (404.4 sq. feet)

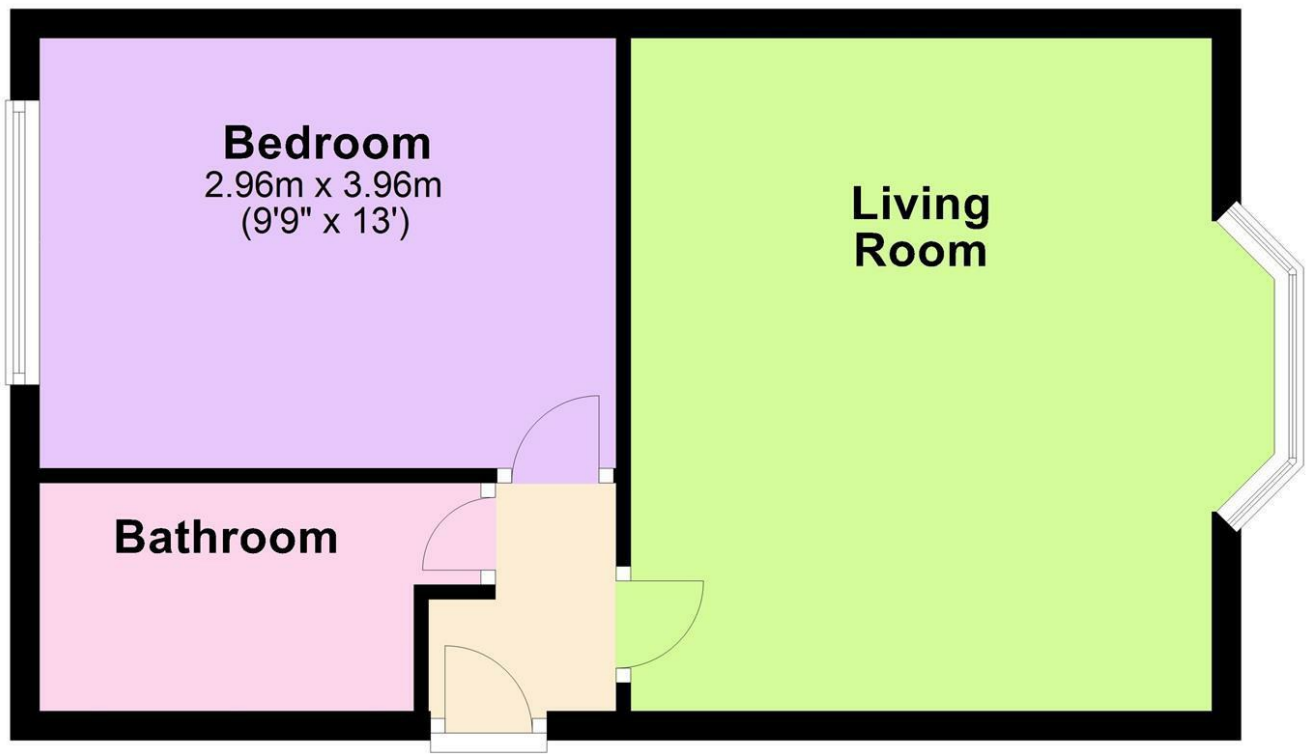

Total area: approx. 37.6 sq. metres (404.4 sq. feet)

These particulars, whilst believed to be accurate are set out as a general outline only for guidance and do not constitute any part of an offer or contract. Intending purchasers should not rely on them as statements of representation of fact, but must satisfy themselves by inspection or otherwise as to their accuracy. No person in this firms employment has the authority to make or give any representation or warranty in respect of the property.

